



Symantec Enterprise Security Manager™

Comprehensive Policy and Compliance Management

The complexity of today's heterogeneous, multi-tiered enterprise makes it a major challenge to create, measure, and comply with policies that meet regulatory guidelines while securing the confidentiality, integrity, and availability of corporate assets. With constantly shifting combinations of operating platforms and new applications, plus the emergence of multi-faceted, "blended" security threats like CodeRed and Nimda, the challenge has become even more daunting. By automating and centralizing policy compliance management and security assessments across the enterprise from a single location, Symantec Enterprise Security Manager (ESM) provides an effective management solution that helps ensure compliance and protect mission-critical systems.

> **Automation that delivers policy management and compliance**

Symantec Enterprise Security Manager provides comprehensive security policy compliance management of mission critical e-Business applications and operating systems. From a single location, it automates the discovery of policy deviations and vulnerabilities for services housing mission-critical applications and data on the network, across the enterprise. With its intelligent tools, administrators can quickly and cost effectively create baselines and measure performance against those baselines to identify systems that are not in compliance and correct faulty settings to bring systems back into compliance. And by automating repetitive operations, it allows administrators to off-load redundant tasks, thereby saving money and freeing up time to fine tune policies to ensure consistent regulatory compliance and maximum security.

> **A comprehensive, multi-platform solution**

As a comprehensive solution, Symantec Enterprise Security Manager performs over 1,500 checks, automatically assessing policy compliance and security on servers, workstations, routers, hubs, applications, and even databases. It easily scales to support large installations of thousands of systems running multiple operating systems such as Windows NT,® Windows® 2000, Novell NetWare,® OpenVMS,™ Linux® and most varieties of UNIX,® with minimal network impact. And it integrates smoothly into existing network services management systems including HP OpenView,™ Tivoli® Enterprise, and BMC PATROL.®

KEY POINTS

- > Proactively reduces corporate risk with automated policy compliance management tools
- > ESM Application Modules protect mission-critical applications to ensure compliance management with policies and regulations based on ISO 17799
- > Industry-specific security policies help organizations cost effectively comply with regulations such as HIPAA and GLBA
- > Conducts security assessments for mission-critical e-business applications and operating systems, noting deviations from policies such as inappropriate settings and incorrect system configurations
- > Checks policy compliance and vulnerabilities on servers, workstations, applications, and databases with over 1,500 assessments
- > Performs assessments fast and efficiently, with minimal disruption to day-to-day business operations
- > Manages enterprise-wide policy compliance from a central console, with easy and secure updating over the Internet via LiveUpdate™ integration
- > Provides integrity checks as well as comprehensive reports and compliance management recommendations
- > Operates on Windows® NT 4.0, Windows 2000,™ Windows XP,™ Solaris,™ HP-UX,™ AIX, Linux,® IRIX, Digital UNIX,® NetWare,® Sequent, and VMS™
- > Backed by Symantec™ Security Response, the world's leading Internet security research and support organization

> Management intelligence that's easy to manage

To gain a high-level view of policy management and the ability to analyze compliance issues, Symantec Enterprise Security Manager enables administrators to generate pre-configured or customized management reports detailing policy compliance and security vulnerabilities—from both inside the enterprise and from the Internet. The solution is easily and rapidly deployed, comes pre-configured to help meet industry standards, including ISO 17799, HIPAA, and more. Plus, with its integrated LiveUpdate™ automated functionality, administrators can safely deploy the latest compliance updates and security check agents from a central console via the Web or corporate intranets.

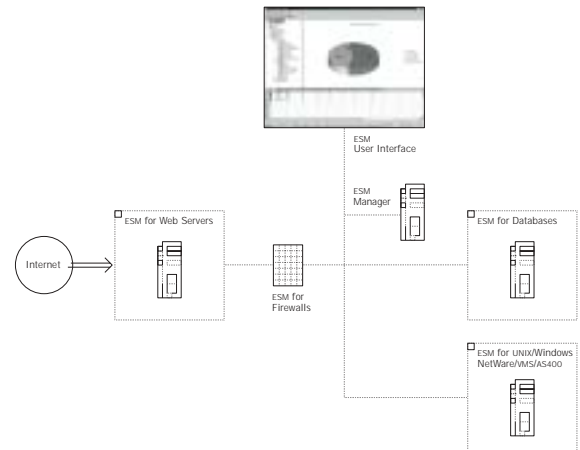

Symantec Enterprise Security Manager defines policy online in a database and automatically measures compliance across the network. The processes it utilizes to analyze data are tuned for high efficiency, enabling each console to accommodate up to 15,000 agents divided over several managers.

> Symantec Enterprise Security Manager application modules

While it is a challenge managing and securing operating systems, applications can be much more elusive. And with mission-critical business processes increasingly dependent on applications, strong security becomes paramount. Databases contain millions of dollars worth of information, Web servers mirror a company's image on the Internet, and firewalls protect company assets and customer confidentiality from hackers. Symantec Enterprise Security Manager application modules are plug-and-protect preventative solutions developed to extend policy management and security assessments beyond the operating system in order to ensure compliance and protect mission-critical e-business systems.

Operating systems and applications used to conduct business are frequently subject to vulnerabilities such as bugs in the code, improper settings, or weak configurations that open the door to security risks and intrusion. And with the increasing complexity of applications and the growth of heterogeneous operating environments, vulnerabilities are appearing with increased frequency.

Based on ISO 17799, and other industry best practices, standards, and research, Symantec Enterprise Security Manager application modules include pre-configured policies for protecting specific application and operating system combinations from unique vulnerabilities. To maximize the confidentiality, integrity, and availability of data, policies are designed for highly specific combinations, such as Oracle® 8i on Solaris® 8, and not for the least common denominator.

By introducing application-specific executables and content, including checks for password strength, patches, and unneeded services, Symantec Enterprise Security Manager application modules ease the administrative burden of measuring the effectiveness of policies and enforcing compliance. With the modules, Symantec Enterprise Security Manager's centralized scanning and integrated reporting capabilities can be utilized to automate evaluations and policy enforcement to protect Web servers, databases, firewalls, and other application servers from vulnerabilities and non-compliance.



Symantec Enterprise Security Manager applications modules are completely integrated into the system.

Optional Symantec Enterprise Security Manager application modules include:

- ESM for AntiVirus (Symantec AntiVirus™ Corporate Edition)
- ESM for Databases (Oracle)
- ESM for Firewalls (CheckPoint and Symantec Enterprise Firewall)
- ESM for Web Servers (IIS, iPlanet, and Apache)

> **Symantec Enterprise Security Manager™ 5.5**

New Symantec Enterprise Security Manager updates are developed constantly and posted on the Symantec Security Response Web site twice a month at <http://securityresponse.symantec.com>. They are available for download via subscription. Check the Web site for availability of new and updated policies.

ESM APPLICATION MODULES FOR ANTIVIRUS

- Symantec AntiVirus Corporate Edition 8.0 on Windows NT® 4 Server-17799
- Symantec AntiVirus Corporate Edition 8.0 on Windows® 2000 Server-17799

ESM APPLICATION MODULES FOR WEB SERVERS

- IIS 4 on Windows NT 4 Server-17799
- IIS 5 on Windows 2000 Server-17799
- Apache® 1.3.x on RedHat® Linux 6.1 and 7.0 Server-17799
- iPlanet® 4.1 on Solaris® 2.6-17799
- iPlanet 5.x on Solaris 8-17799

ESM APPLICATION MODULES FOR DATABASES

- Oracle® 7.3.4 on Solaris-17799
- Oracle 7.3.4 on HP-UX® 10.x and 11-17799
- Oracle 8i on Solaris-17799
- Oracle 8i on HP-UX 10.x and 11-17799

ESM APPLICATION MODULES FOR FIREWALLS

- CheckPoint™ FW-14.1 on Windows NT 4 Server-17799
- Raptor™ 6.5 on Solaris 8 -17799

ESM FOR OPERATING SYSTEMS

- Solaris 2.6–8-17799
- RedHat Linux 6.1–7.0-17799
- Windows 2000-17799
- Windows NT 4-17799
- HP-UX 11.x-17799
- HP-UX 10.20-17799
- AIX® 4.3.2+-17799

> World-class service and support from Symantec™ Security Response

Like all Symantec security technologies, Symantec Enterprise Security Manager benefits from the technical support and service provided by Symantec Security Response—the world's leading Internet security research and support organization. Symantec Security Response helps organizations keep their security and management systems optimized and effective in the face of the latest threats with around-the-clock vigilance and response. Symantec Security Response provides rapid emergency response, delivering the latest security and compliance checks 24 hours a day. And with Symantec's exclusive LiveUpdate™ capability, updates can be automatically deployed worldwide in just minutes.

> Optimize policy management effectiveness with Symantec Security Services

Because of the complexity of today's networked environments, new compliance and security issues are constantly emerging. That's why many companies turn to Symantec Security Services to help keep their Symantec Enterprise Security Manager system up-to-date and working optimally. Symantec Security Services offers a comprehensive array of management, monitoring, and response services that help organizations solve security problems cost effectively. Symantec Managed Vulnerability Assessment Services, for instance, provides world-class analysis using security and compliance tools and industry-leading security expertise to help organizations eliminate the most exploitable vulnerabilities. It's a highly effective and economical way to discover gaps and develop policies for strengthening policy compliance and the protection of mission-critical systems.

POLICY COMPLIANCE MANAGEMENT TECHNOLOGY IS A KEY COMPONENT OF SYMANTEC ENTERPRISE SECURITY. SYMANTEC ENTERPRISE SECURITY COMBINES WORLD-CLASS TECHNOLOGIES, COMPREHENSIVE SERVICES, AND GLOBAL EMERGENCY RESPONSE TEAMS TO HELP BUSINESSES RUN SECURELY AND WITH CONFIDENCE.

PLATFORM AND SOFTWARE SUPPORT SYMANTEC ENTERPRISE SECURITY MANAGER VERSION 5.5

- Windows® XP
- Windows 2000 (Professional, Server, Advanced Server)
- Windows NT® 4.0
- IBM® AIX®
- HP-UX®
- Sun® Solaris®
- RedHat® Linux®
- SGI® IRIX
- Sequent® PTX
- Compaq® True64
- Novell® NetWare®
- OpenVMS (AXP)
- IBM iSeries (AS/400)

WORLD HEADQUARTERS

20330 Stevens Creek Blvd.
Cupertino, CA 95014 U.S.A.
1.408.253.9600
1.800.441.7234

www.symantec.com

For Product Information
In the U.S., call toll-free
800.745.6054.

Symantec has worldwide
operations in 38 countries.
For specific country
offices and contact numbers
please visit our Web site.